

Aluminum systems

Sliding and folding systems - practical solutions for years



Lift-slide doors ULTRAGLIDE

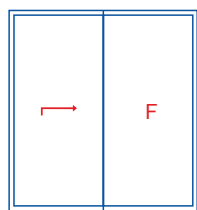

Diagram A

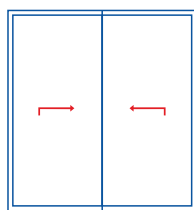

Diagram D

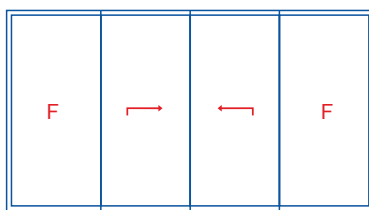

Diagram C

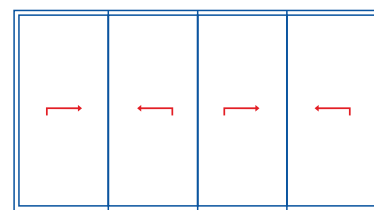

Diagram F

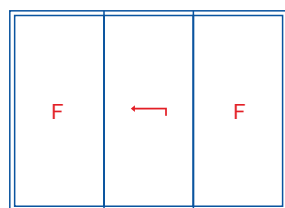

Diagram G

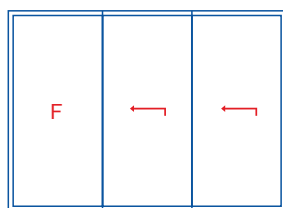

Diagram A + G

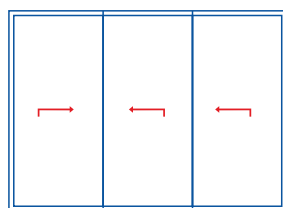

Diagram D + G

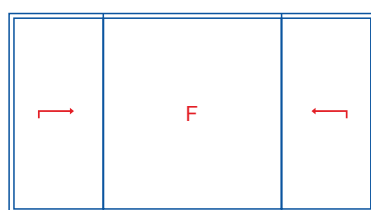

Diagram K

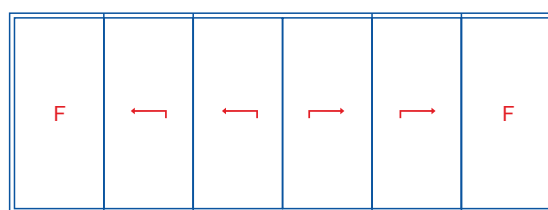

Diagram C + G + G

Folding doors PANORAMA

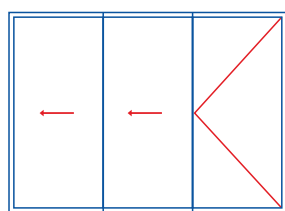

Diagram 321

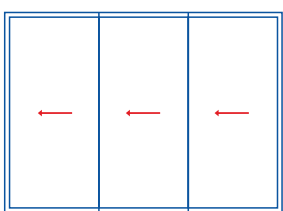

Diagram 330

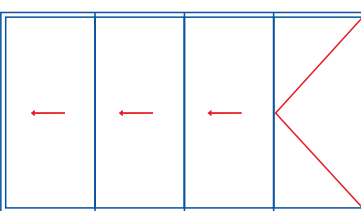

Diagram 431

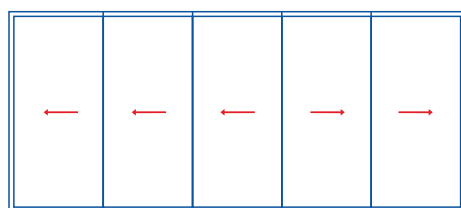

Diagram 532

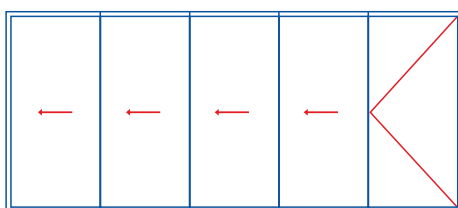

Diagram 541

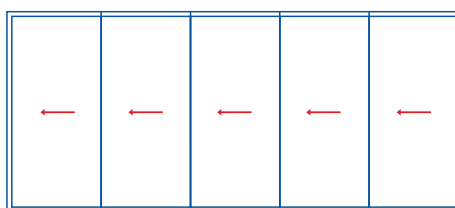

Diagram 550

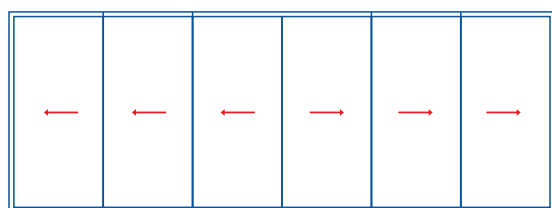

Diagram 633

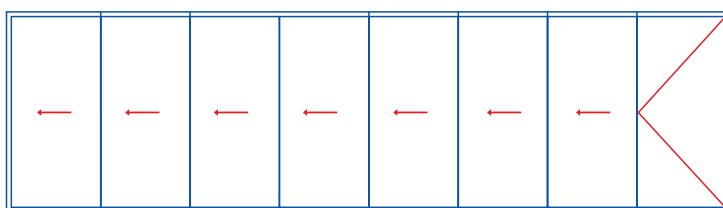

Diagram 871

SLIDE GLASS

LIGHT AND SLIM CONSTRUCTION

The system uses aluminum profiles with minimal visibility, which gives the impression of being slim and light and gives maximum transparency and visual simplicity of the structure. In this system maximum sash dimensions are 2600 × 500-1600 mm and the maximum sash weight – 80 kg. Guides with 3, 4 or 5 tracks can be used.

LOTS OF SOLUTIONS

Slide Glass allows you to choose different joint solutions. In the Slide Glass system a profileless labyrinth joint (without sealing) or joint between moving sashes with a narrow brush profile can be used.

DEDICATED SOLUTIONS

The system includes dedicated fittings: trolleys with or without adjustment, handles attached to the glass and special hook locks. It can be locked with a built-in or a side lock.



CROSS OVERVIEW OF THE SYSTEM SLIDE GLASS

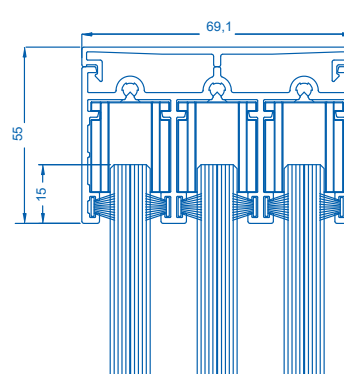
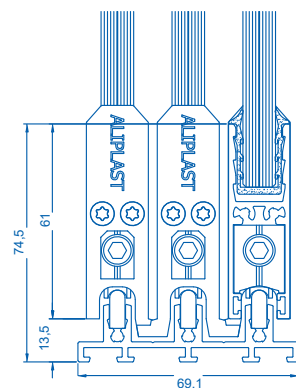
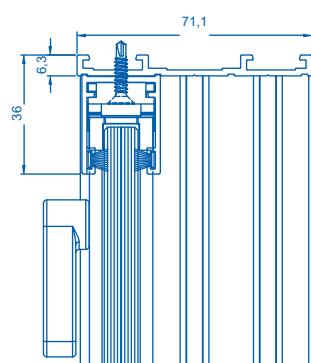
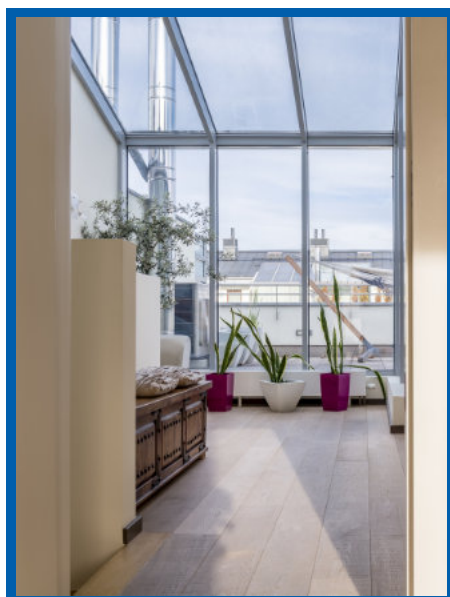

MODERN SLIDE

TECHNICAL PROPERTIES

Modern Slide is a modern and slender aluminum sliding system characterized by increased level of thermal insulation. The system allows to create of sliding structures on 2,3,4-track frames and is dedicated for use in public utility facilities as well as residential and individual buildings. The system includes a unique Galandage design solution that allows you to open doors by completely hiding a door sashes in chambers in the building wall. Thanks to the minimum width of the connection of two sashes (35 mm) and profiles available in three versions adapted to different strength requirements, the Modern Slide system is characterized by lightness and modernity. By choosing Modern Slide you are choosing one of the most innovative and flexible sliding systems on the market!

LOTS OF SOLUTIONS

In addition to the Galandage technical solution, the Modern Slide system also has a solution called Monoblock, which allows the construction to be installed in insulation layer located inside the rooms. The system enables the construction of leaves up to 250 kg and glazing with glass packet up to 32 mm thick.

THE GALANDAGE SOLUTION

This system meets requirements of the French market in terms of aesthetics and the highest production quality. Thanks to the Galandage solution well-known on the French market, which allows you to hide a sash in the wall totally, Modern Slide is one of the most popular systems often chosen by customers in France.

MAXIMUM POSSIBILITIES

Modern Slide allows you to choose from four opening patterns. The options are: Scheme D (2 active sashes), Scheme D + G (3 active sashes), Scheme F (4 active sashes) and 6 active sashes system. Max glazing dimensions: 4000 × 2500 mm for 2-sash structures, 4000 × 2700 mm for 3-sash structures and 4000 × 2400 mm for 4-sash structures.

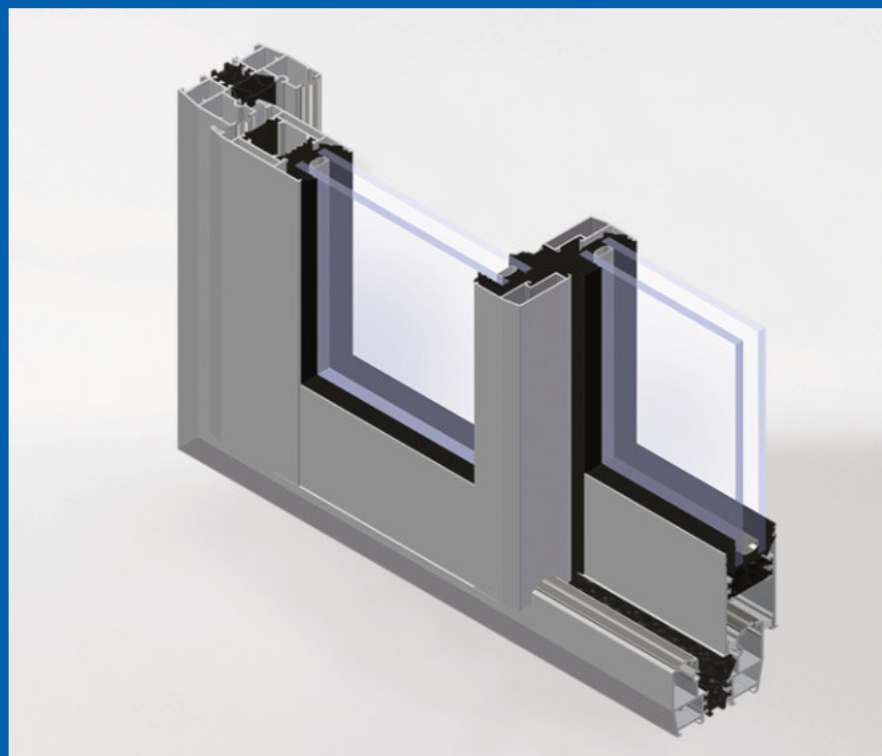

CROSS OVERVIEW OF THE SYSTEM MODERN SLIDE

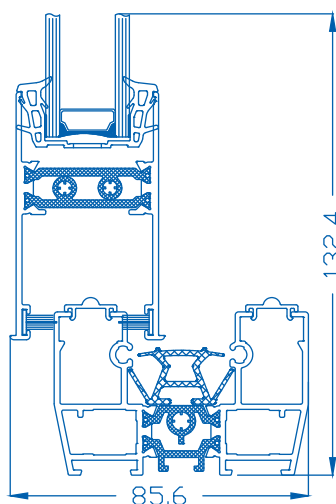

Cross-section through threshold

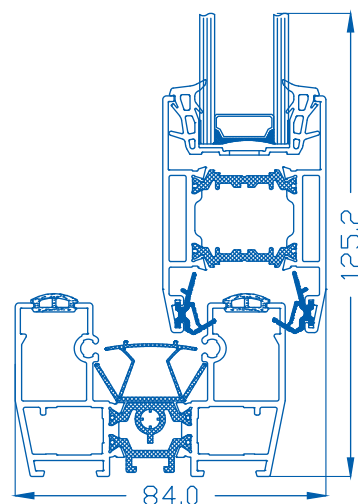

Cross-section through frame

TECHNICAL PROPERTIES

A three-chamber sliding system with thermal separators made of higher thermal insulation material, perfect for verandas, terraces, winter gardens and patios in residential buildings as well as modern public spaces. The standard width of the frame installation is **117.7 mm**, and the sashes **43 mm**, with the possibility of glazing up to 36 mm.

HIGH FUNCTIONALITY

The Visoglide Plus system can be made on the basis of a two- or three-track frame, which enables the assembly of a functional structure with even 6 elements.

AESTHETICS

Extremely **narrow labyrinth post** with a width of 34 mm makes sliding and lift-slide doors light and slim based on the Visoglide Plus system, therefore perfectly fit into requirements of modern architecture.

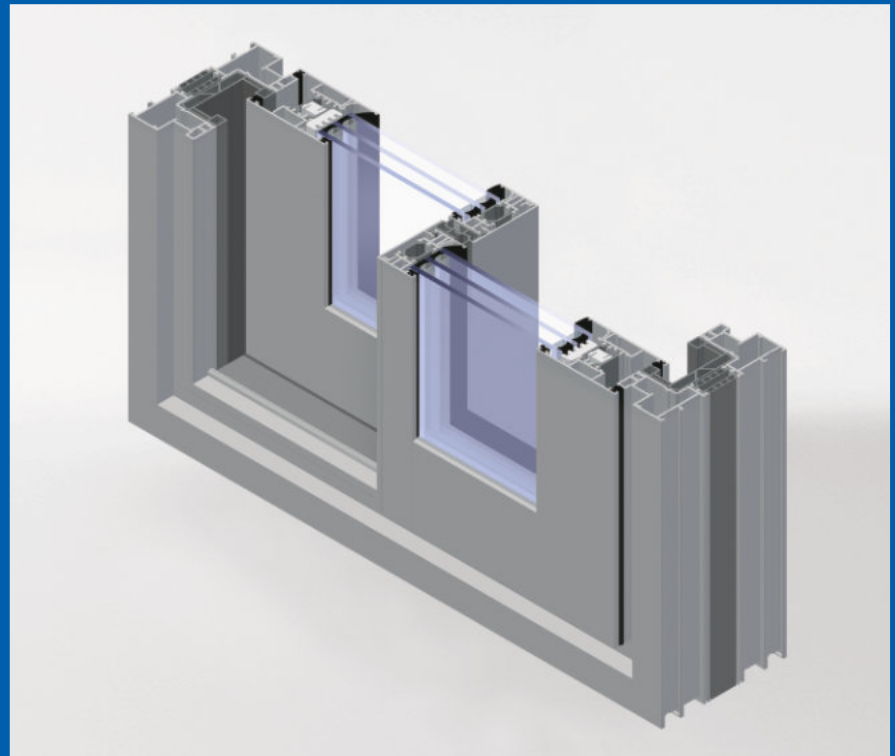

CROSS OVERVIEW OF THE SYSTEM VISOGLIDE

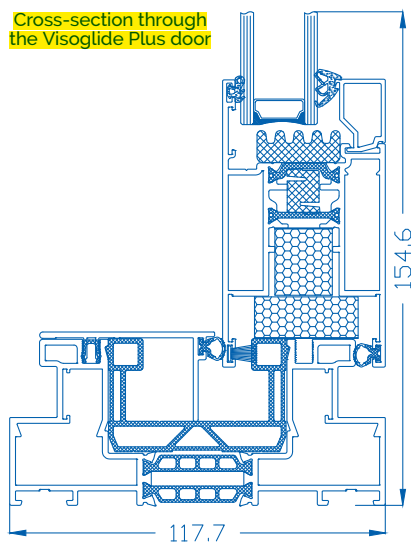
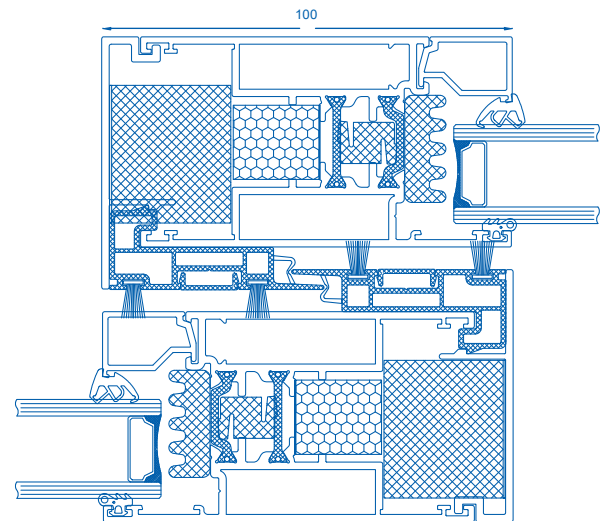
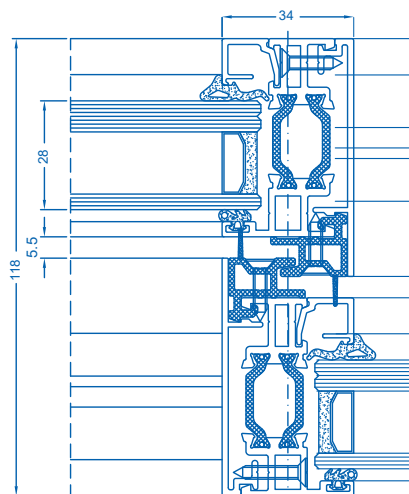
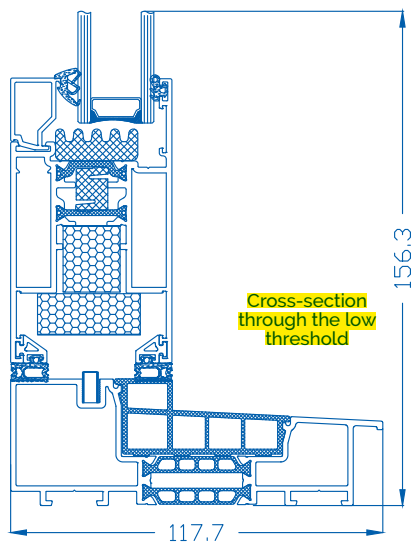

ULTRA WARM SYSTEM

Ultraglide is an ideal system to create sliding and lift-slide doors with high thermal insulation parameters. The standard system includes a wide frame of **153 mm** (2-rail) or **239 mm** (3-rail) and wide thermal separator gained up with glass-fiber. The use of additional thermal breaks **UG i** and **UG i+** combined with glazing up to **49 mm** additionally improves already good thermal properties.

COMFORT OF USE

A low doorstep option ensures comfortable use of the sliding structure and elegant design. This model makes it much easier for users with disabilities to move between rooms, because it prevents a level differences at the door-floor interface, and allows the doorstep to **be levelled with the floor**. Profiles are adapted for installation of many manually and automatically locked fittings available on the market, so you can choose a solution that ensures easy and comfortable door usage.

LOTS OF SOLUTIONS

Sliding and lift-slide structures made of Ultraglide System have an extremely wide range of solutions, customized to individual customer requirements. The system enables the design of doors with a **low doorstep** as well as an **angular connection of 90°**, in addition the 2- or 3-rail frame supports the design of sliding sashes in any configuration.

STABILITY AND AESTHETICS

The Ultraglide system enables the design of large, stable and functional glazing, delivering perfect light to the room. Sashes can be designed **up to 3.3 m high** and **3.2 m wide** and the wing weight up to 400 kg in the lift-slide option. The elegant look of the structure allows for a creative interior design.

CROSS OVERVIEW OF THE SYSTEM ULTRAGLIDE

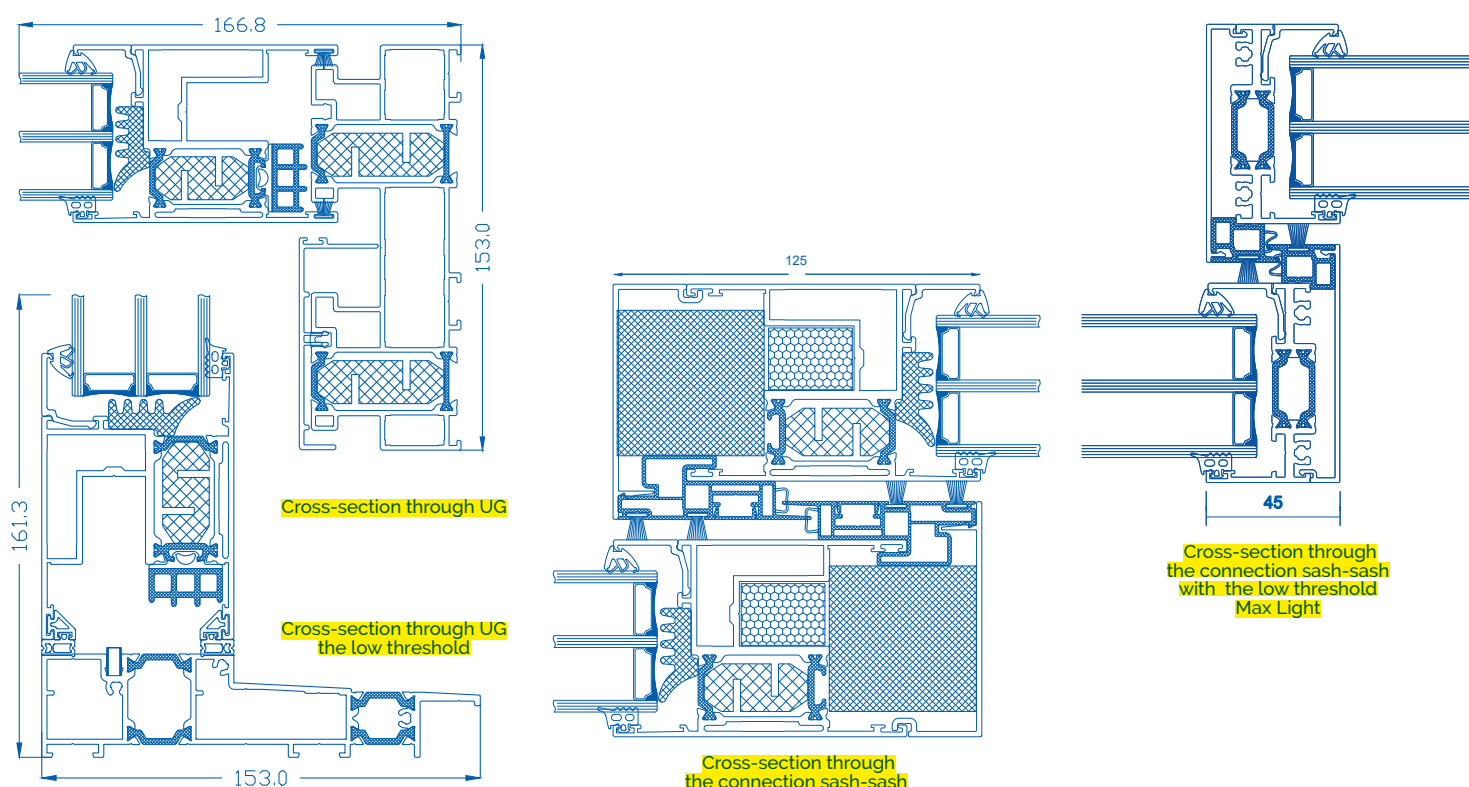

FOLDING DOOR SYSTEM – PANORAMA

THERMAL PROPERTIES

An insulated three-chamber system intended for the design of folding doors enabling the arrangement of wide open passages in residential buildings and in public facilities such as restaurants, swimming pools. Also available in a version with higher thermal insulation, **Panorama DV i+**, with a **U_f coefficient of 1.33 W/m²K**, thanks to the use of thermal inserts around the perimeter and between the sash and frame spacers. As standard, the depth of the frame and sash is 74.5 mm, and **the weight of the sash can reach 100 kg**.

WIDE RANGE OF SOLUTIONS

The Panorama system is the perfect solution for joining or separating rooms. Individual elements can slide to the right or left and open inwards or outwards in many configurations (2 + 1, 3 + 2, 3 + 3 etc.). It is also possible to use two types of doorstep systems: a **flat doorstep** with a brush gasket or a doorstep based on complete frame. After opening, the wings can be parked from the inside or outside.

AESTHETICS

The system is a perfect joint between external and internal spaces, giving the impression of their integration. New integrated fittings reduce the overall dimensions of complex structure and improve its functionality and stability at the same time. The whole structure is characterized by lightness and a modern look.

CROSS OVERVIEW OF THE SYSTEM PANORAMA

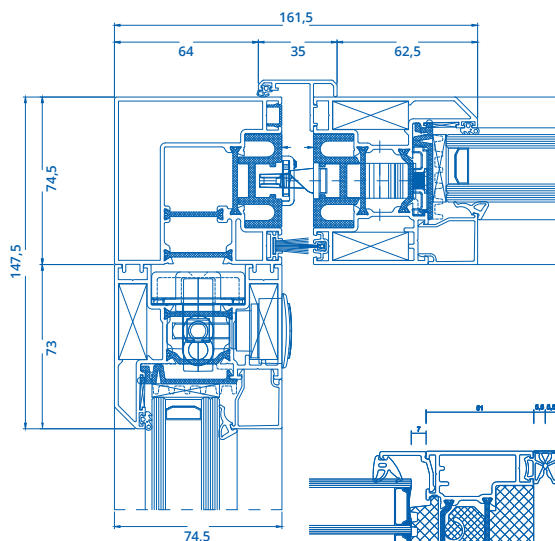

Cross-section through the corner folding element 90

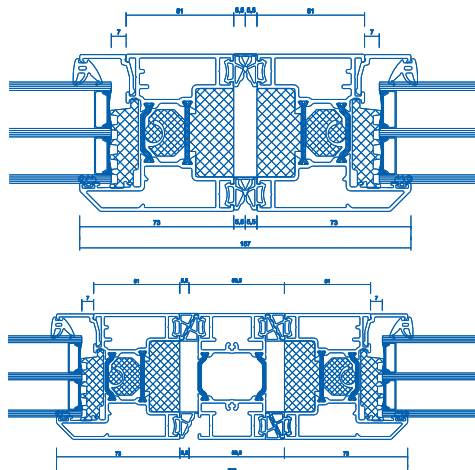

Cross-section through the sash type A / type B

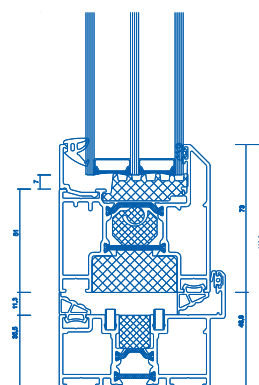
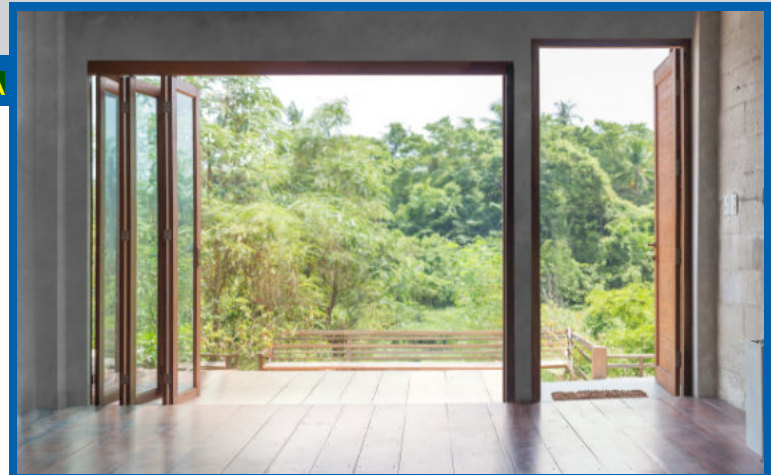

Cross-section through the low threshold

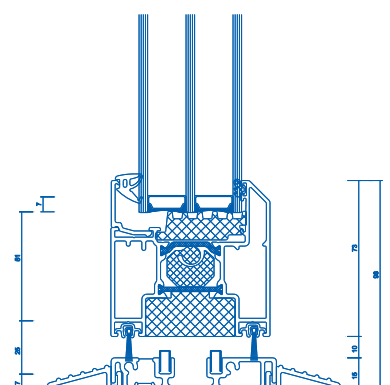

Cross-section through the sash in frame

SAMPLE COLOR PALETTE

Aliplast windows and doors are available in all RAL colours. In addition, they can be made in the Aliplast Wood Colour Effect palette, which perfectly reflects the beauty of wood-like colours or in the palette of Tiger and IGP structural coatings with a characteristic texture, with a choice of gloss, the so-called pearl or without. Also an interesting solution is an option of creating a two-colour structure of inner and outer profiles with a different colour each.

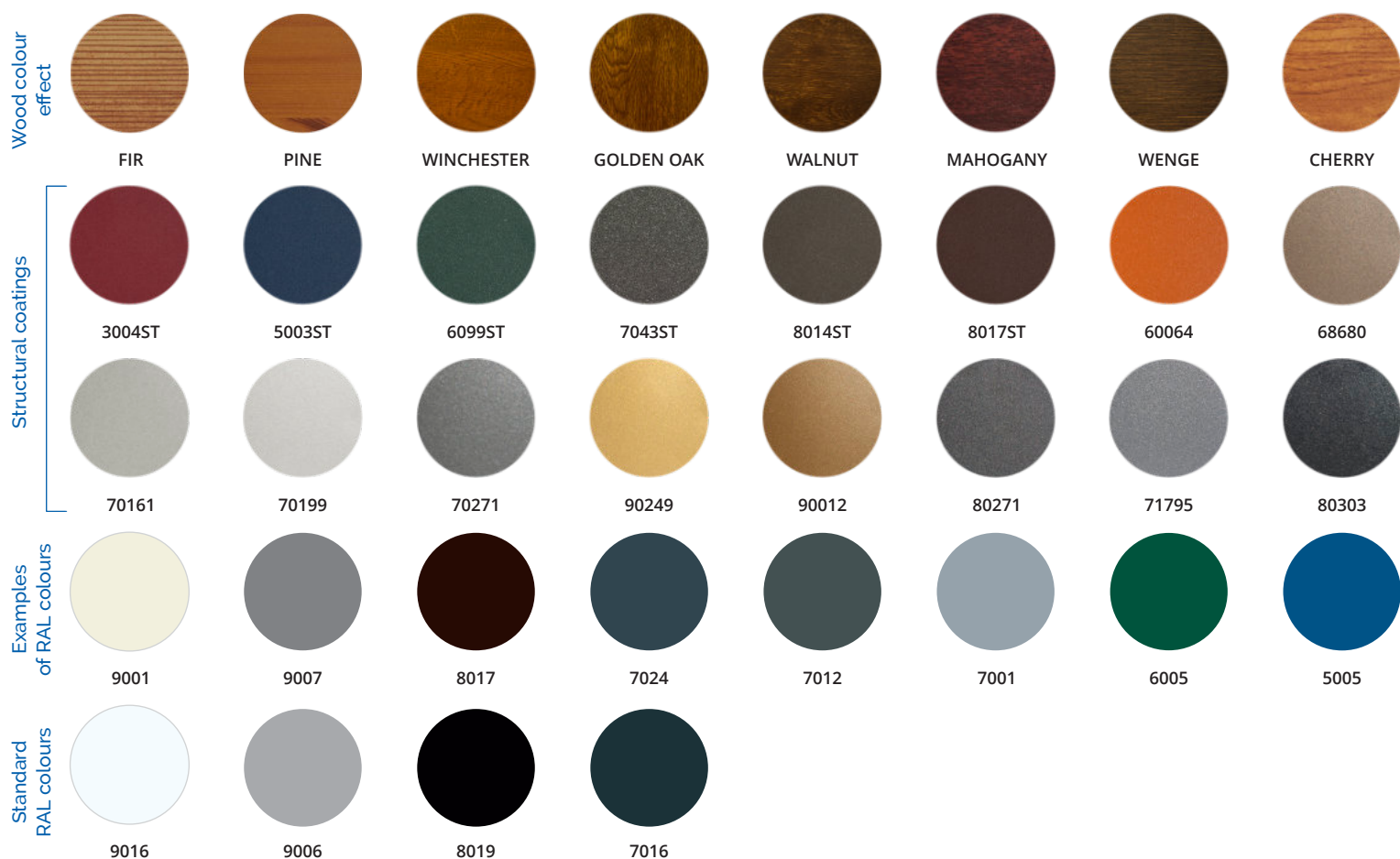

TECHNICAL SPECIFICATIONS

SYSTEM	TYPE	THERMAL INSULATION U_f^*	FRAME DEPTH	SASH DEPTH	GLAZING THICKNESS
SLIDE GLASS	slide	-	from 690 mm to 1130 mm	-	10 mm
MODERN SLIDE	slide	U_f from 1.50 W/m²K	from 73.8 mm to 195.9 mm	44 mm	24/28/32 mm
VISOGLIDE PLUS	slide lift and slide	U_f from 2.10 W/m²K	118/142/184 mm	51 mm	6-36 mm option monorail: 18-60 mm
ULTRALIDE	slide lift and slide	U_f from 1.45 W/m²K	from 153 mm to 239 mm	67 mm	sash 14-52 mm
ULTRALIDE I+	slide lift and slide	U_f from 1.13 W/m²K	from 153 mm do 239 mm	67 mm	sash 14-52 mm
ULTRALIDE go	slide lift and slide	U_f from 1.45 W/m²K	from 153 mm to 239 mm	67 mm	sash 14-52 mm
ULTRALIDE low threshold	lift and slide	U_f from 1.45 W/m²K	from 153 mm to 239 mm	67 mm	sash 14-52 mm
PANORAMA	folding door	U_f from 1.68 W/m²K	74.5 mm	74.5 mm	16-50 mm
PANORAMA I+	folding door	U_f from 1.33 W/m²K	74.5 mm	74.5 mm	16-50 mm



*Thermal insulation is dependent on a combination of profiles and thickness of the filling

BUSINESS PARTNER